

# WATER Brush

Ideal for water color drawing and coloring.



Size: S



**BR-GS-101S**

Pack Size: 24 packs / bag  
Size: S

RRP:



## HOW TO USE:

1. Add water to the barrel reservoir. Screw the barrel onto the tip section, turning it counterclockwise.

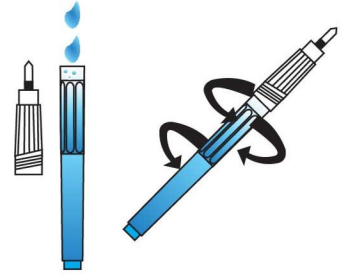

2. Remove the nib cap and squeeze the barrel until water appears at the brush fibers.

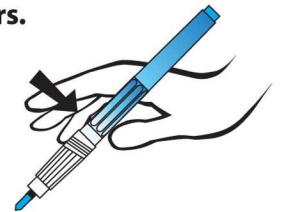

## Brush Care:

Rinse the brush tip to keep it clean.  
Do not let the paint dry on the nylon fibers.  
Drain the barrel and dry brush tip if not in used for a long period.  
Use the nib cap to preserve brush quality.  
\* Brush made by nylon fibers.



Caution

Keep out of children's reach.



Size: M



**BR-GS-102M**

Pack Size: 24 packs / bag  
Size: M

RRP:



Size: L



**BR-GS-103L**

Pack Size: 24 packs / bag  
Size: L

RRP:

